

CNRS Nucléaire & particules

CC-IN2P3 status report

DECALOG Workshop

LPNHE, Paris, January 2026

- **Some news from CC-IN2P3**
 - Resources
 - New computing room (Vil3)
- **GPU**
 - JupyterLab (L40S)
 - Slurm (V100 et H100)
- **Orchestration (OpenShift)**
- **Conclusion & perspectives**

IN2P3 Computing Center overview



- **Resources**

- 81 people (77 engineers, 3 people in the research team, and 1 trainee, 63 BAP E)
- Budget 2025: 7.1 M€ (HR excluded)
- Budget 2026: not known yet (possible 15% cut)
- 2.5 M€ buildings (incl. 1.7 M€ for electricity)
- 4 M€ computing (incl. 2 for WLCG) & 0.4 M€ running costs

- **Facilities**

- 1700 m2 over two computing rooms
- New room Vil3 just built (December '25)

- **Computing**

- ~800 servers, 1060 kHS06
- 4 ARM workers available (test)

- **Storage**

- Tapes: ~570 PB (full capacity, new tape system installed in Fall'25)
- HDDs: ~75 PB (installed)

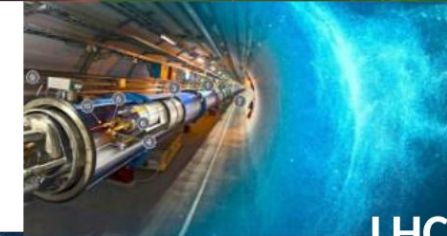
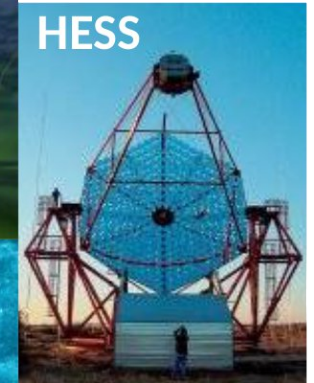

Evolution du Calcul au CC-IN2P3 depuis 2000

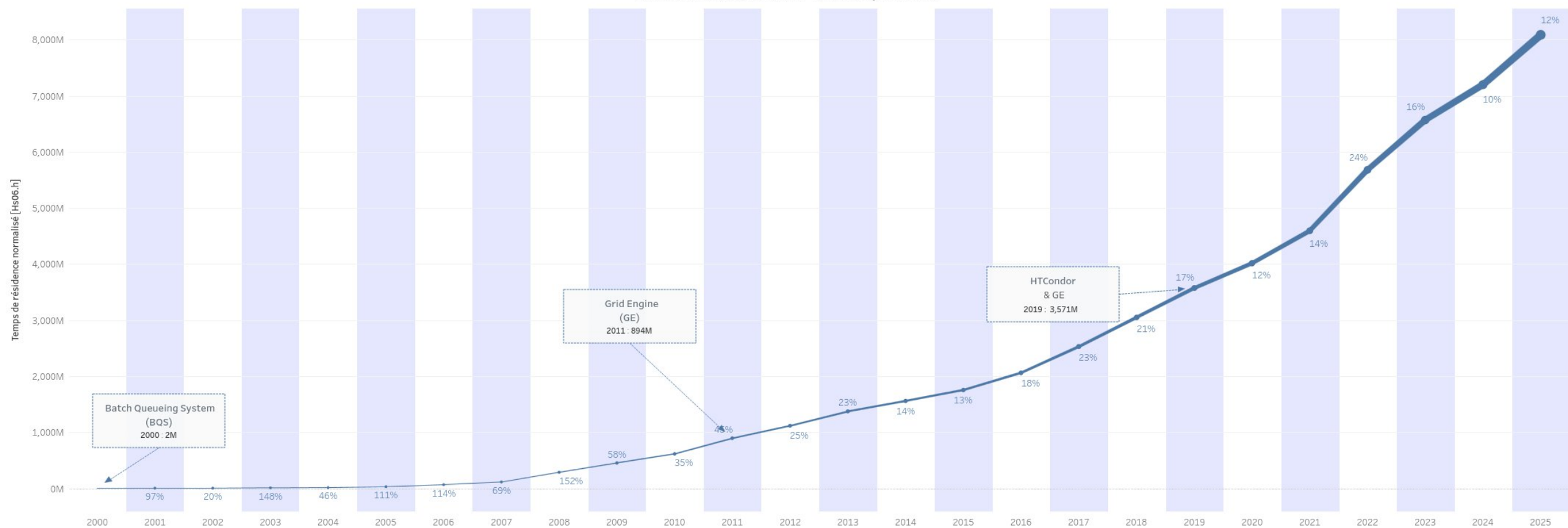

Storage



Evolution du stockage Total utilisé
-Espace mensuel maximum utilisé sur la période-

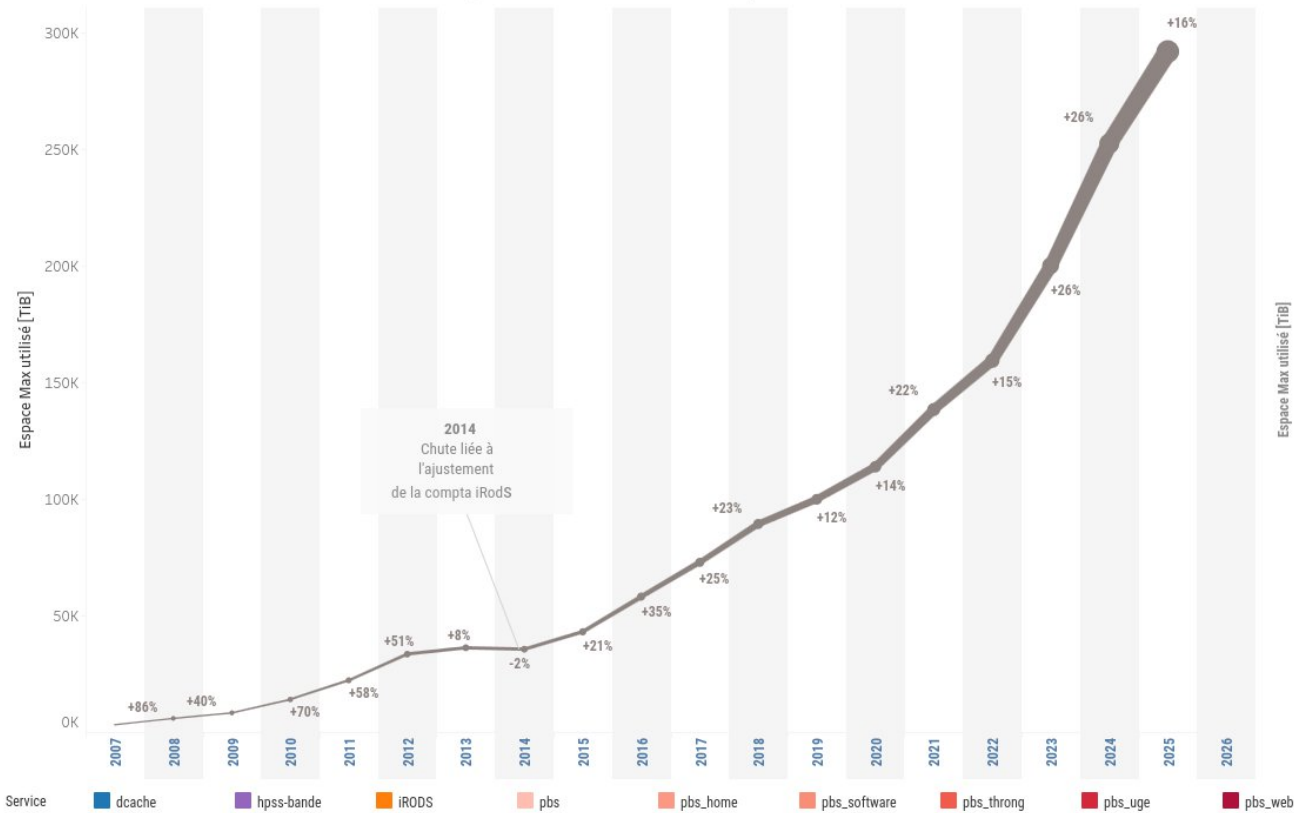

Détail du stockage utilisé par Service
-Espace mensuel maximum utilisé sur la période pour chaque Service-

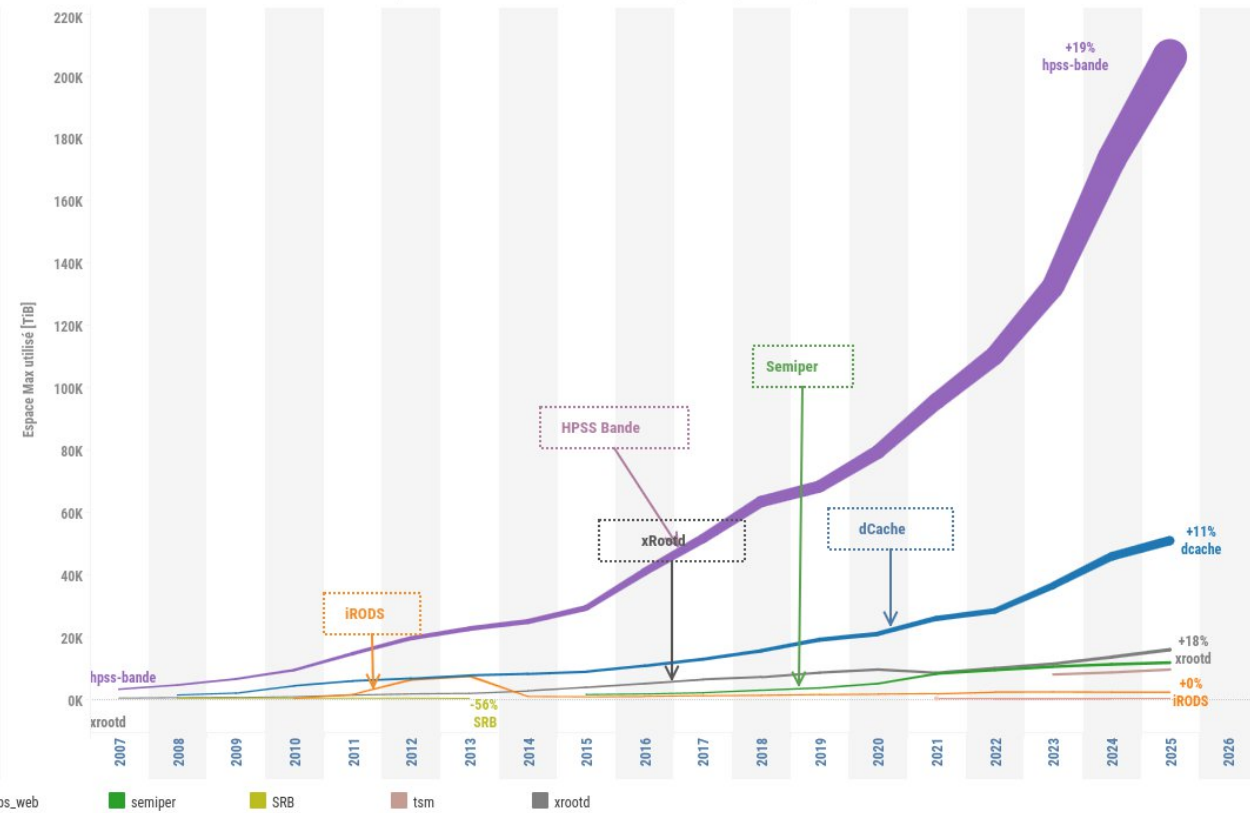

Disk Size Distribution (TB)

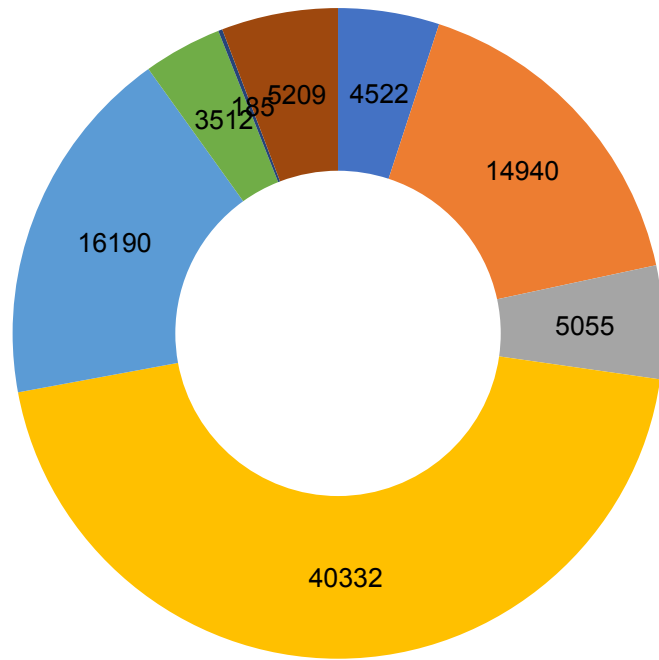

Tape Size Distribution (TB)

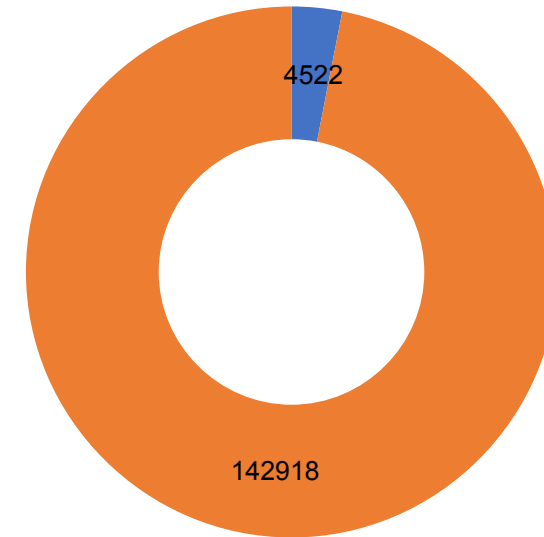

New Computing Room vil3

New room partly funded through FITS Equipex (national project with IDRIS)

- Target usage: research infrastructure hosting
 - will allow to move remaining IT services from Vil1 to Vil3
- Construction completed on December 25
- 2MW IT at term (130 racks, 15KW)
- ~9 M€ without IT

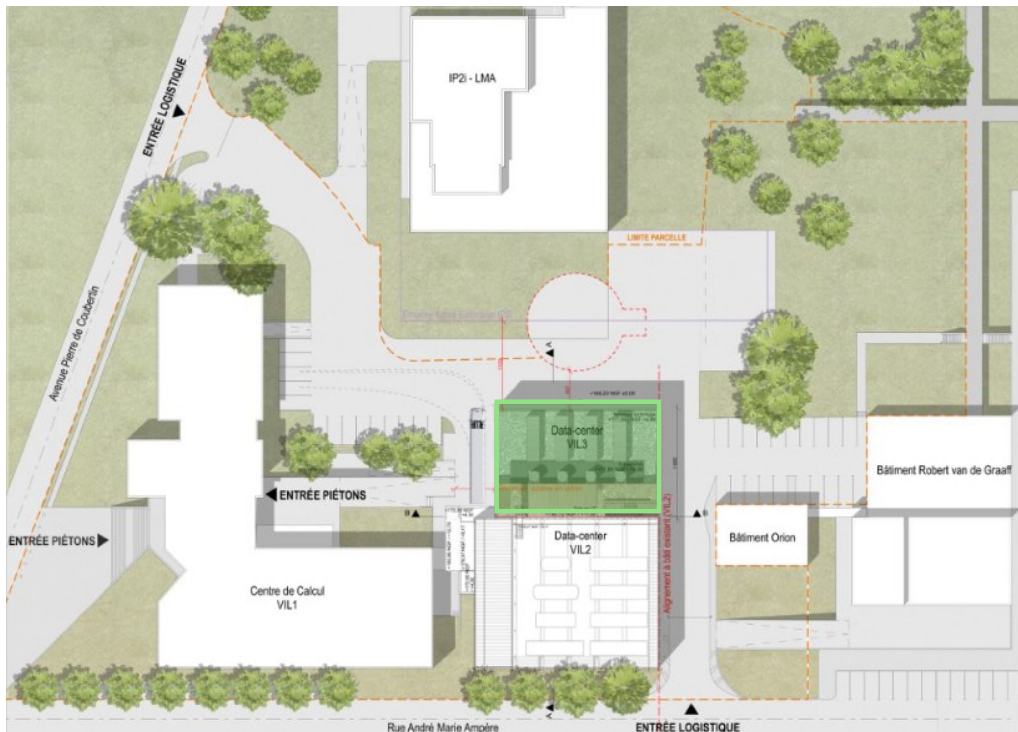

DECALOG Workshop - January 26



New GPUs installed in 2025



- **New GPUs installed in JupyterLab and Slurm in 2025**
 - provided (and bought) by Huma-Num
- **In Slurm**
 - already installed V100
 - PowerEdge C4140
 - 18 workers, **72 GPUs, with 192GB memory per worker**
 - installed in Spring 25' H100 NVL
 - ProLiant DL385 Gen11
 - 4 workers, **16 GPUs, with 1,5TB of memory per worker**
- **In JupyterLab**
 - installed in Spring 25' L40S
 - ProLiant DL385 Gen11
 - 8 workers, **30 GPUs, with 768GB of memory per worker**

Orchestration



- Administrator
- Home
 - Overview
 - Projects
 - Search
 - API Explorer
 - Events
- Operators
- Workloads
- Networking
- Storage
- Builds
- Observe
- Compute
- User Management
- Administration

Overview

Cluster

Details [View settings](#)

Cluster API address
https://api.wok2.in2p3.fr:6443

Cluster ID
[Redacted]

Infrastructure provider
None

OpenShift version
[Redacted]

Update channel
[Redacted]

Cluster inventory

- 15 Nodes 2 ! 3 ↻
- 1285 Pods
- 2 StorageClasses
- 359 PersistentVolumeClaims

Status [View alerts](#)

Cluster Control Plane Operators 3 upgrade available Insights Disabled Dynamic Plugins

- ! [Redacted] [View details](#)
- ! [Redacted] [View details](#)
- ! [Redacted] [View details](#)

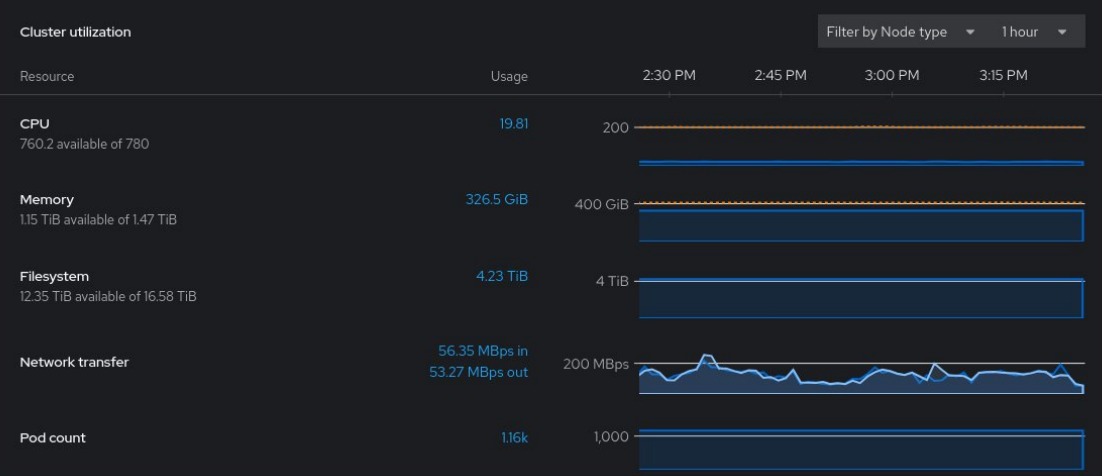

Activity [View events](#)

Ongoing

There are no ongoing activities.

Recent events [Pause](#)

- 3:36 PM ! [View details](#)
bbq-api-v1-2-python-cert-1-1417170609-1655288283
(combined from similar events): Error presenting challenge: services "cm-acme-http-solver-85m2x" is forbidden: exceeded quota: ccin2p3-bbq-prod-quota, requested: services=1, used: services=10, limited: services=10
- 3:36 PM J Job completed
- 3:36 PM P Created container clear-expired-sessions
- 3:36 PM P Add eth0 [172.19.35.120/23] from ovn-kubernetes
- 3:36 PM P Created container consume-messages
- 3:36 PM P Started container clear-expired-sessions
- 3:36 PM P Successfully pulled image "gitlab-registry.in2p3.fr/..."
- 3:36 PM P Pulling image "gitlab-registry.in2p3.fr/..."
- 3:36 PM P Started container consume-messages
- 3:36 PM P Successfully pulled image "gitlab-registry.in2p3.fr/..."
- 3:36 PM J Created pod: canyon-production-php-clear-expired-session...
- 3:36 PM P Add eth0 [172.19.38.120/23] from ovn-kubernetes
- 3:36 PM J Created pod: canyon-production-php-consume-messages-2...
- 3:36 PM P Pulling image "gitlab-registry.in2p3.fr/..."
- 3:36 PM P Successfully assigned ccin2p3-canyon/canyon-production-p...
- 3:36 PM P Successfully assigned ccin2p3-canyon/canyon-production-p...

- Production platform for application services only, based on OpenShift
 - ~300 projects (namespaces)
 - ~120 cc-in2p3
 - ~100 hosted
 - we are providing and hosting WordPress based websites
 - ~80 from collaboration
 - we are only providing a “empty” namespace, and the collaboration is responsible to deploy and maintain their own applications.
- No test or computing instance
 - for such needs, please contact David Bouvet ('Accompagnement' team) with a precise usecase and requirements and the request will be evaluated.

Conclusion & Perspectives



- **Still unknown about the 2026 budget**
 - possible 15% cut
- **Hardwares prices are increasing**
 - memory by ~50%
 - Nvidia GPU by a factor of ~3 !
- **Hopefully WLCG hardware renewal almost completed**
 - but no “extra” hardware purchase foreseen, i.e. no GPU
- **For R&D needs not covered by the actual CC-IN2P3 services (such as k8s) contact David Bouvet**