

# Some additional information on the used tools and good practices @ CCIN2P3

---

Mariangela Settimo



# IN2P3 Computing Centre

Scientific computing and data processing

More information

<https://cc.in2p3.fr/en/>

# DAMIC-M @ CCIN2P3

- **Access to the cluster for all collaborators**
- **Ask the account :** <http://cctools.in2p3.fr/cclogon/>

**Page 1)** If you are in France, choose your laboratory. Otherwise select the option “Other laboratories contributing with IN2P3 and COLLAB.ETRANGER.PHYS.”

**Page 2)** Select “DAMIC” as your experience.

**Page 3)** Click on the button “Print as pdf”, date and sign and send a copy to your system administrator (for French members) or to [mariangela.settimo@subatech.in2p3.fr](mailto:mariangela.settimo@subatech.in2p3.fr).

## CC LOGON

Step 1 of 3  
Ask for a new account in CC-IN2P3

Step 2 of 3

### Account Properties

Department and laboratory:

First Name: \*

Last Name: \*

Desired Login Name: \*

My account already exists or I am moving to a new laboratory.

\* required fields.

**User support :** [cc-usersupport.in2p3.fr](mailto:cc-usersupport.in2p3.fr)

**Mailing list:** <http://listserv.in2p3.fr>

**Gitlab repository :** [gitlab.in2p3.fr](https://gitlab.in2p3.fr)

**JupyterLab**

<https://notebook.cc.in2p3.fr/hub/login>

**SQL / MongoDB servers and web host**

# DAMIC-M @ CCIN2P3

---

Please visit the following page for a correct use of :

## **DISK SPACE:**

<https://doc.cc.in2p3.fr/en/Data-storage/storage-areas.html#storage-areas>

a few tens of TB allocated each year for DAMIC under  
[/sps/hep/damic/](#)

**No backup done.**

Create here your working directory.

A few GB available in your home (daily backup)

# Computing

---

Please visit the following page for a correct use of :

## **Interactive server : limited use**

<https://doc.cc.in2p3.fr/en/Getting-started/access/cca-best-practices.html>

## **Batch system (job scheduler) : limited use**

<https://doc.cc.in2p3.fr/en/Computing/computing-introduction.html>

Please always inform M.S. and the analysis task before starting time consuming or disk consuming production so we coordinate and ensure resource

If you have special requests please ask MS

For technical problems related to DAMIC software please ask Nuria, Mariangela or Claudia.

For connection problems you may also ask to the CCIN2P3 user-support.



# For those who never used gitlab or git commands in CCIN2P3:

1. Login to [gitlab.in2p3.fr](https://gitlab.in2p3.fr) (using Shibboleth and your email address where you received the invitations)

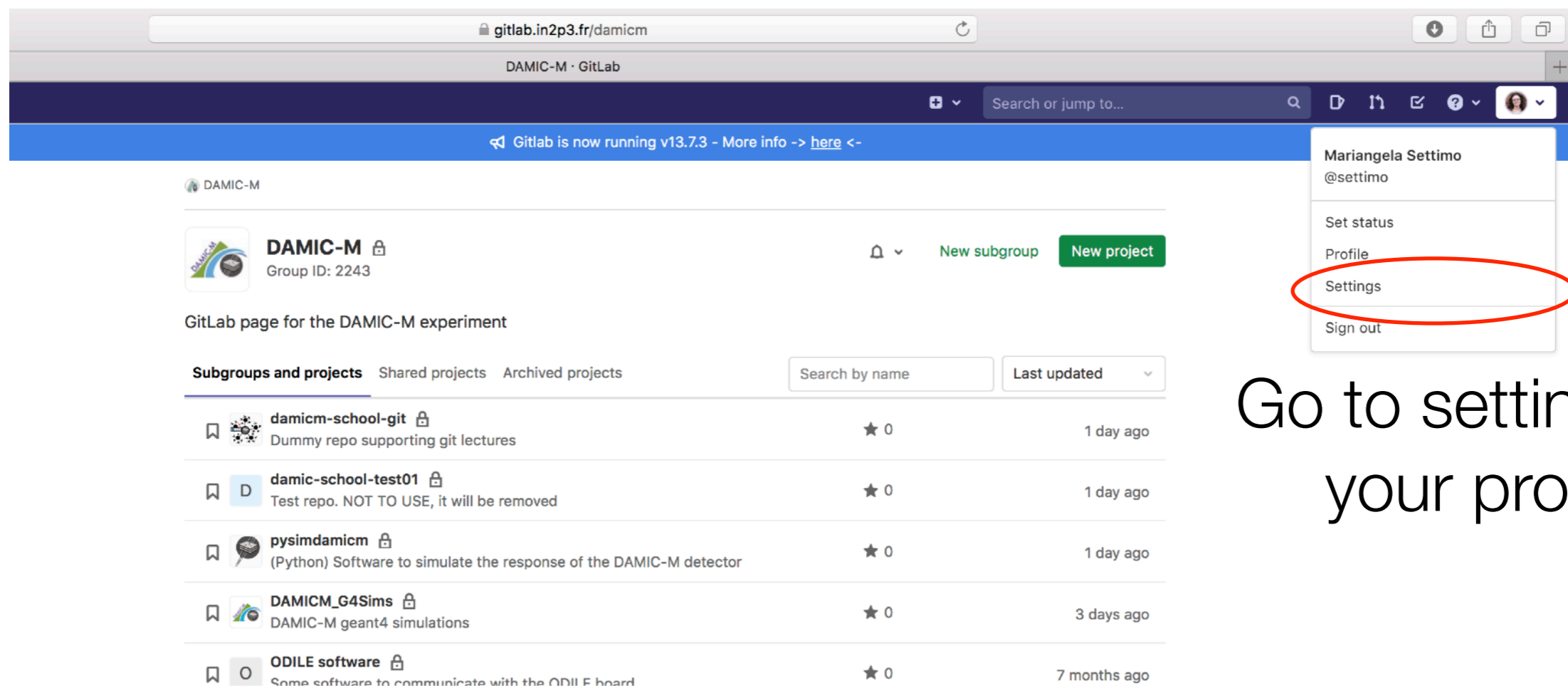

The screenshot shows the GitLab web interface for the DAMIC-M group. The user profile dropdown menu is open, showing options like 'Set status', 'Profile', 'Settings', and 'Sign out'. The 'Settings' option is circled in red.

**DAMIC-M**  
Group ID: 2243

GitLab page for the DAMIC-M experiment

**Subgroups and projects** | Shared projects | Archived projects

Project Name	Description	Stars	Last Updated
damicm-school-git	Dummy repo supporting git lectures	0	1 day ago
damic-school-test01	Test repo. NOT TO USE, it will be removed	0	1 day ago
pysimdamicm	(Python) Software to simulate the response of the DAMIC-M detector	0	1 day ago
DAMICM_G4Sims	DAMIC-M geant4 simulations	0	3 days ago
ODILE software	Some software to communicate with the ODILE board	0	7 months ago

Go to settings in your profile

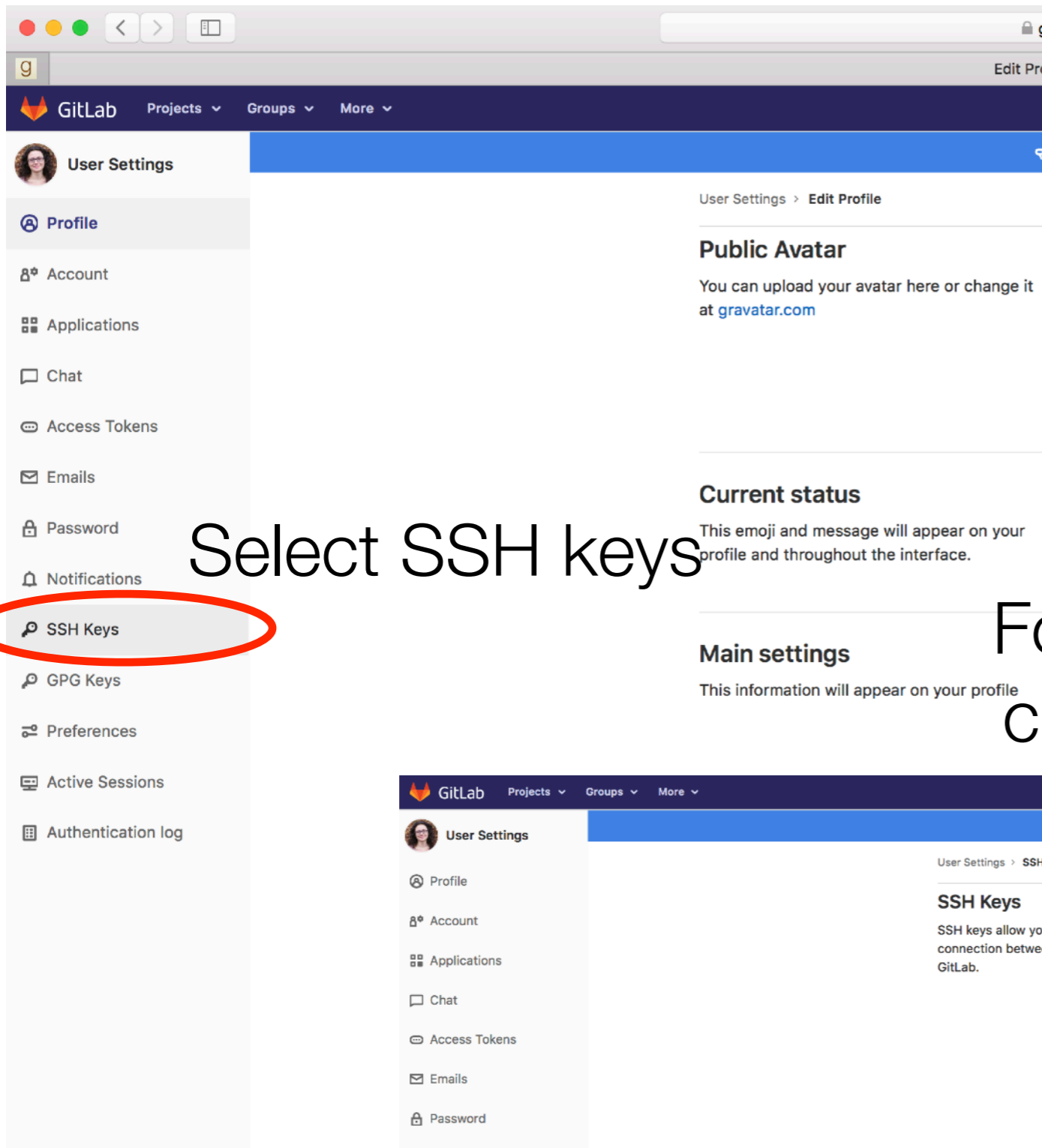

Select SSH keys

Follow the instructions here to create the public/private keys

