



ConstructionDB: Suivi de construction et de configuration de détecteurs



Cécile AUFRANC, Guillaume BAULIEU, Noël GIRAUD, Olivier STEZOWSKI



Principe

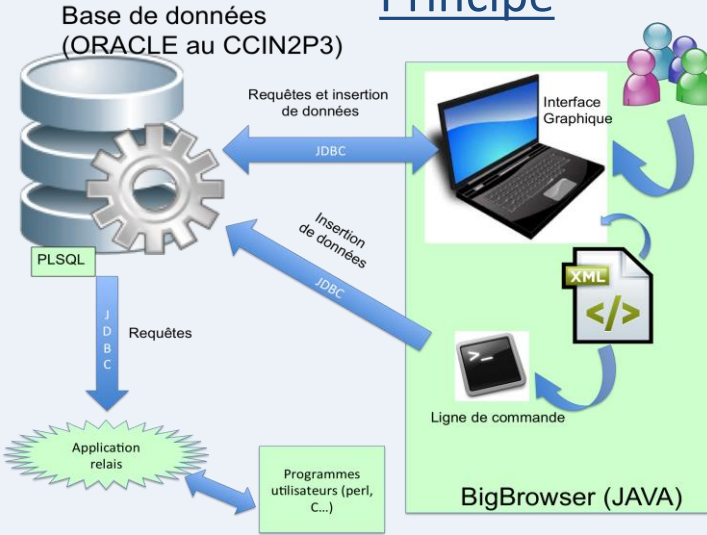

Fonctionnalités

ConstructionDB

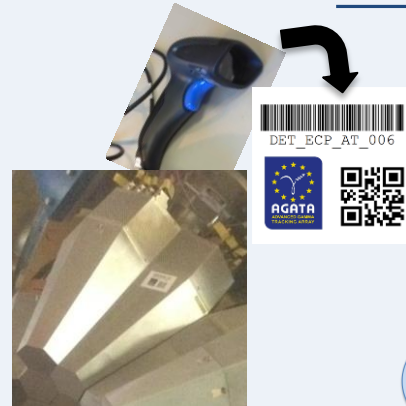
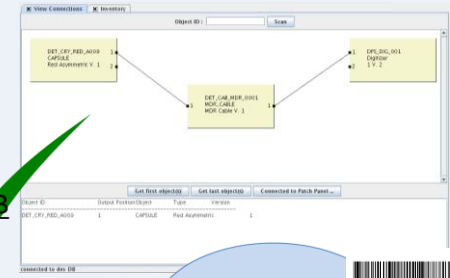
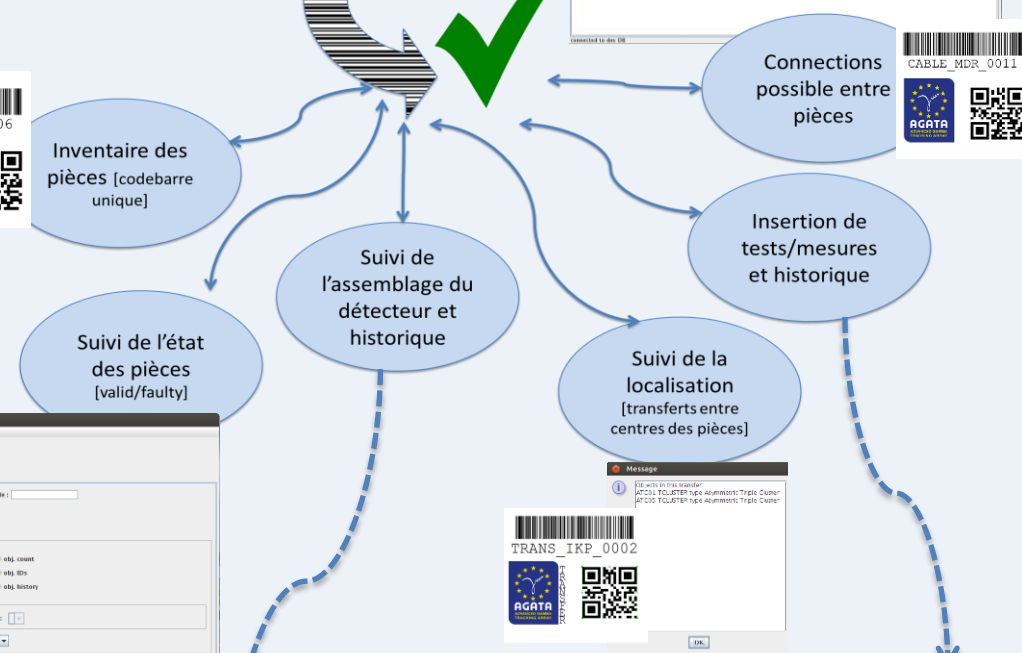

AGATA Database Navigator - Inventories

OBJECT_ID	OBJET	FAULTY	CAPSULE	OBJECT	Green (R)	TYPE-DESCRIPTION	VERSION	SEQUENCE
DET_CAP_GRE_0008	IBRD		CAPSULE	Green (R)	LL	2013-11-21 10:26:40		
DET_CAP_GRE_0010	IBRD		CAPSULE	Green (R)	LL	2013-11-21 10:26:40		
DET_CAP_GRE_0011	IBRD		CAPSULE	Green (R)	LL	2013-11-21 10:26:40		
DET_CAP_GRE_0012	IBRD		CAPSULE	Green (R)	LL	2013-11-21 10:26:40		
DET_CAP_GRE_0013	IBRD		CAPSULE	Green (R)	LL	2013-11-21 10:26:40		
DET_CAP_GRE_0014	IBRD		CAPSULE	Green (R)	LL	2013-11-21 10:26:40		
DET_CAP_GRE_0015	IBRD		CAPSULE	Green (R)	LL	2013-11-21 10:26:40		
DET_CAP_GRE_0016	IBRD		CAPSULE	Green (R)	LL	2013-11-21 10:26:40		
DET_CAP_GRE_0017	IBRD		CAPSULE	Green (R)	LL	2013-11-21 10:26:40		
DET_CAP_GRE_0018	IBRD		CAPSULE	Green (R)	LL	2013-11-21 10:26:40		
DET_CAP_GRE_0019	IBRD		CAPSULE	Green (R)	LL	2013-11-21 10:26:40		
DET_CAP_GRE_0020	IBRD		CAPSULE	Green (R)	LL	2013-11-21 10:26:40		
DET_CAP_GRE_0021	IBRD		CAPSULE	Green (R)	LL	2013-11-21 10:26:40		
DET_CAP_GRE_0022	IBRD		CAPSULE	Green (R)	LL	2013-11-21 10:26:40		
DET_CAP_GRE_0023	IBRD		CAPSULE	Green (R)	LL	2013-11-21 10:26:40		
DET_CAP_GRE_0024	IBRD		CAPSULE	Green (R)	LL	2013-11-21 10:26:40		
DET_CAP_GRE_0025	IBRD		CAPSULE	Green (R)	LL	2013-11-21 10:26:40		
DET_CAP_GRE_0026	IBRD		CAPSULE	Green (R)	LL	2013-11-21 10:26:40		
DET_CAP_GRE_0027	IBRD		CAPSULE	Green (R)	LL	2013-11-21 10:26:40		
DET_CAP_GRE_0028	IBRD		CAPSULE	Green (R)	LL	2013-11-21 10:26:40		
DET_CAP_GRE_0029	IBRD		CAPSULE	Green (R)	LL	2013-11-21 10:26:40		
DET_CAP_GRE_0030	IBRD		CAPSULE	Green (R)	LL	2013-11-21 10:26:40		

AGATA Database Navigator - Assembly History Navigator

Object ID: ATC01 | Ref. date chosen YYYY-MM-DD HH24.MS.SS: 2015-06-08 17:48:07 | Date of assembly or de-assembly: 2011-11-30 10:26:01

Composition of ATC01 at the reference date chosen 2015-06-08 17:48:07:

- DET_CAP_GRE_0003: CAPSULE Blue (G) v. 1 -> Assembled at 2012-07-02 17:28:28
- DET_CAP_GRE_0001: CAPSULE Green (G) v. 1 -> Assembled at 2012-07-02 17:28:28
- DET_CAP_GRE_0002: CAPSULE Red (R) v. 1 -> Assembled at 2012-07-02 17:28:28
- DET_CRYO_AT_001: CRYOSTAT Asymmetric Triple v. 1 -> Assembled at 2011-11-30 18:28:16
- DET_ECP_AT_007: ENDCAP Asymmetric Triple v. 1 -> Assembled at 2013-05-23 13:23:48
- DET_PABO_002: PATCHBOX Low Voltage v. 2 -> Assembled at 2014-09-25 13:43:10
- DET_PA_ATC01: PREAMPLIFIC Triple Cluster: position 1-3 for Core, 4-39 for Segment (A->B->C)

Composition of ATC01 at the above date 2011-11-30 10:26:01, date of assembly or de-assembly:

- DET_CAP_BLU_0002: CAPSULE Blue (G) v. 1 -> Assembled at 2011-11-30 10:26:01
- DET_CAP_GRE_0002: CAPSULE Green (G) v. 1 -> Assembled at 2011-11-30 10:26:01
- DET_CAP_RED_0001: CAPSULE Red (R) v. 1 -> Assembled at 2011-11-30 10:26:01

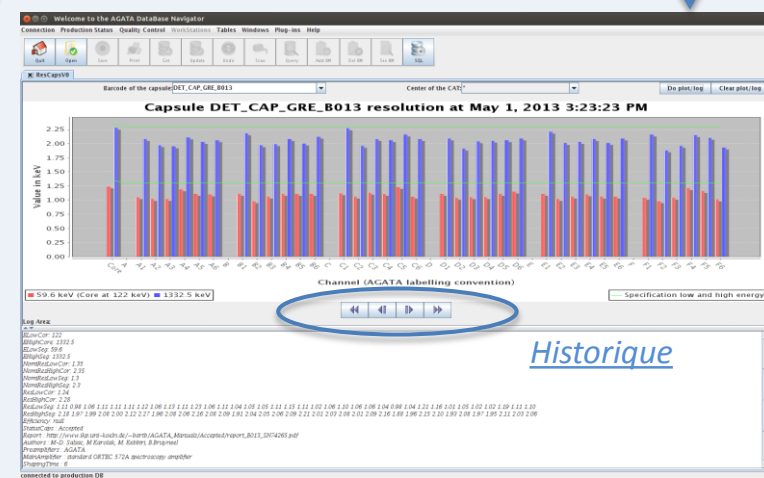

Utilisateurs

